

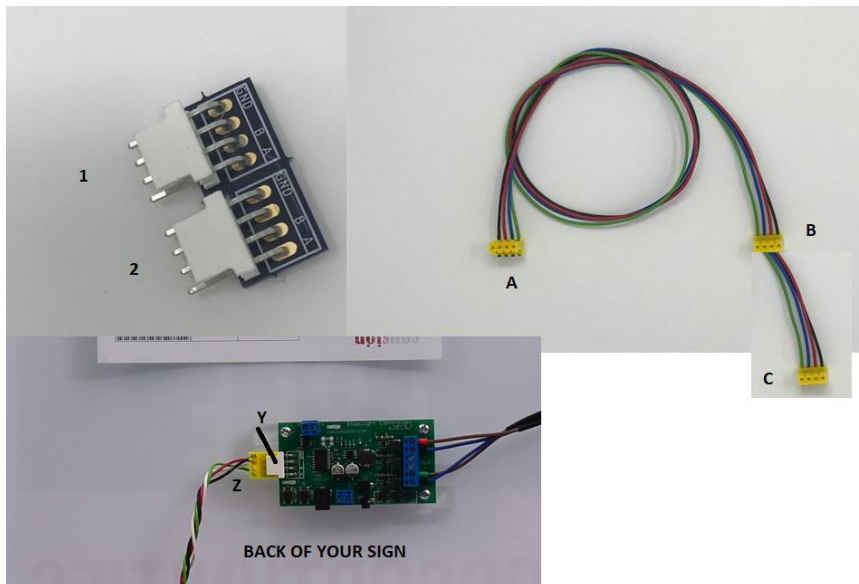

Add Network Controller

This document describes the parts necessary for adding a network controller to an existing sign.



1. Disconnect power from sign.
2. Reference attached picture
3. Unplug yellow connector Z
4. Connect Z to 1
5. Connect C to Y
6. Connect B to 2
7. Connect A to Network controller
8. Mount network controller to back of sign. (epoxy, double stick tape, hot glue, etc)
9. Apply Power to sign

1. Unplug the sign from power.
2. Remove the I/R Sensor cable from whichever device it is plugged into.
3. Mount the network controller in a location where all cables can reach it
 - IR cable can reach
 - Daisy connector can reach both the network controller, and the existing connection point where you are splicing in at
4. Plug I/R Cable to Network Controller

IMPORTANT: plug the IR sensor into 1/8" jack on the daughter card (IR jack), not the main computer board that has the SD card (audio jack)

Cousign Technical Support
269 290-1222

PARTS:

Part Number	Link
DAISY-COUPLER	https://www.cousign.com/daisy-extension-board
DAISY-CABLE-CUSTOM	https://www.cousign.com/daisy-chain-cable
Connectors: 3 Spacing Requirements: "Network Controller Add"	*Customizable product. Please specify details as described to the left.
NETWORK-CONTROLLER	https://www.cousign.com/network-controller